

This drawing is not to be scaled, all figured dimensions to be used.

All Dimensions and cadastral setting out information to be thoroughly checked on site and all or any discrepancies to be reported to the Architect before any work is put in hand.

All work is to comply with the NATIONAL BUILDING REGULATIONS (NBR) AND BUILDING STANDARDS act 103 of 1977 as amended

All work is to comply with all relevant specifications and codes of practice of the SOUTH AFRICAN BUREAU OF STANDARDS (SABS) / SOUTH AFRICAN NATIONAL STANDARDS (SANS) and amendments thereto.

**HEALTH AND SAFETY:** All construction activities to conform to the OCCUPATIONAL HEALTH AND SAFETY ACT 1993 (Act No 85 of 1993)

All materials and workmanship to be as per the MODEL PREAMBLES FOR TRADES 2008, and any further additional preambles as noted in the Bills of Quantities.

All work is to comply with all relevant specifications and codes of practice of the NATIONAL HOME BUILDERS REGISTRATION COUNCIL (NHBR) (Where applicable)

**ELECTRICAL Engineer:** (Where applicable) All materials and workmanship to be as specified on the Consultants drawings.

**STRUCTURAL and CIVIL Engineer:** (Where applicable) All materials and workmanship to be as specified on the Consultants drawings.

**HVAC Engineer:** (Where applicable) All materials and workmanship to be as specified on the Consultants drawings.

**RATIONAL FIRE Engineer:** (Where applicable) All materials and workmanship to be as specified on the Consultants drawings.

**WET SERVICES Engineer:** (Where applicable) All materials and workmanship to be as specified on the Consultants drawings.

**SPECIALIST CONSULTANTS** (Where applicable) All materials and workmanship to be as specified on the Consultants drawing.

**COPYRIGHT:** This drawing remains solely vested in LYT Architecture in terms of COPYRIGHT ACT NO. 98 OF 1978, Amendment Act, no. 9 of 2002. Any reproduction in and to this drawing and the use of intellectual property contained herewith is an infringement of the Act.

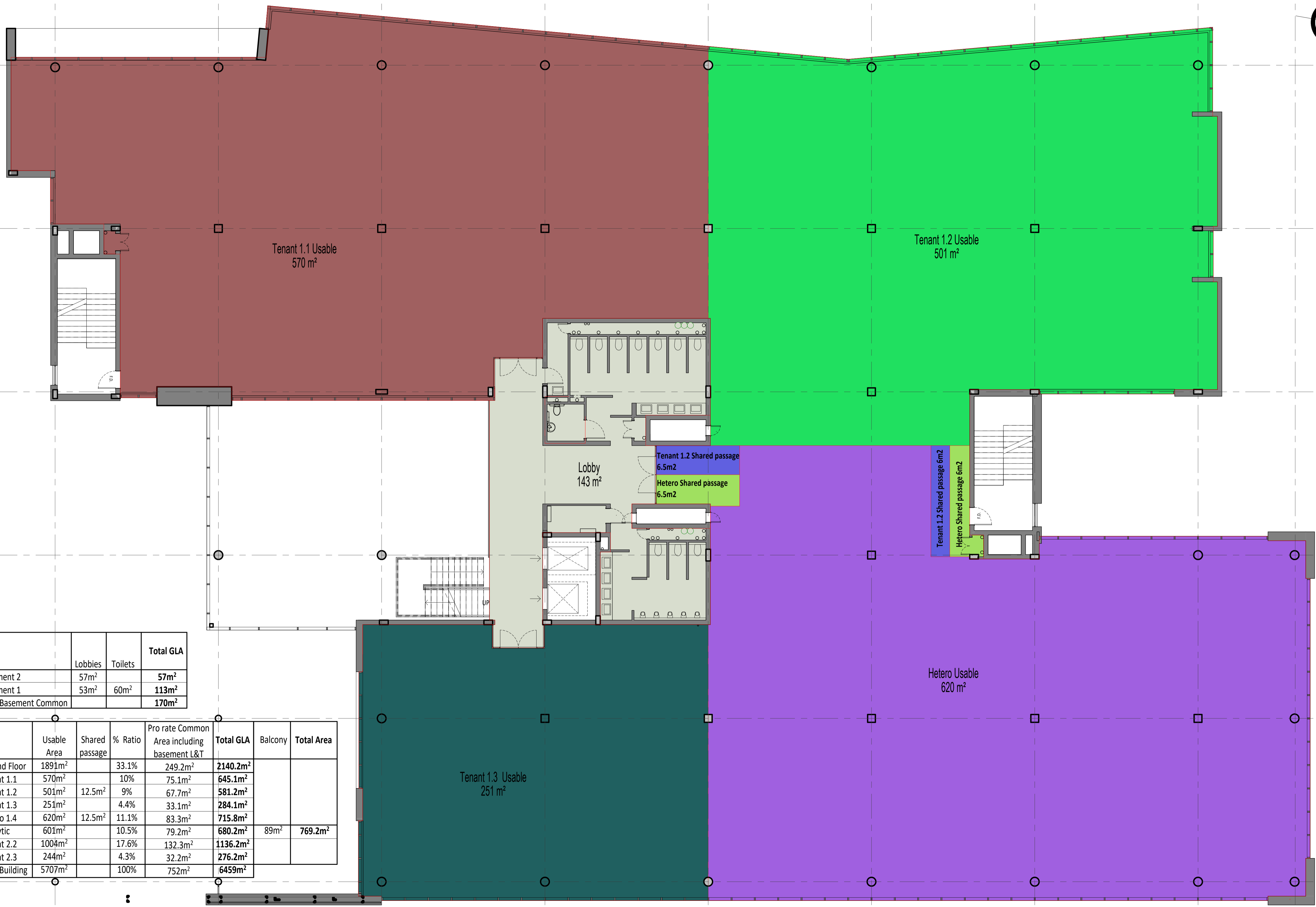
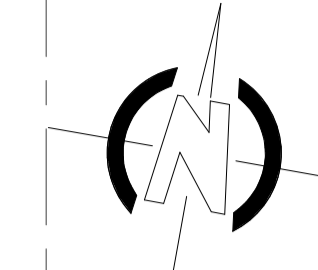

	Lobbies	Toilets	Total GLA
Basement 2	57m <sup>2</sup>		57m <sup>2</sup>
Basement 1	53m <sup>2</sup>	60m <sup>2</sup>	113m <sup>2</sup>
Total Basement Common			170m <sup>2</sup>

	Usable Area	Shared passage	% Ratio	Pro rate Common Area including basement L&T	Total GLA	Balcony	Total Area
Ground Floor	1891m <sup>2</sup>		33.1%	249.2m <sup>2</sup>	2140.2m <sup>2</sup>		
1st Floor							
Tenant 1.1	570m <sup>2</sup>		10%	75.1m <sup>2</sup>	645.1m <sup>2</sup>		
Tenant 1.2	501m <sup>2</sup>	12.5m <sup>2</sup>	9%	67.7m <sup>2</sup>	581.2m <sup>2</sup>		
Tenant 1.3	251m <sup>2</sup>		4.4%	33.1m <sup>2</sup>	284.1m <sup>2</sup>		
Hetero 1.4	620m <sup>2</sup>	12.5m <sup>2</sup>	11.1%	83.3m <sup>2</sup>	715.8m <sup>2</sup>		
2nd Floor							
Catalytic	601m <sup>2</sup>		10.5%	79.2m <sup>2</sup>	680.2m <sup>2</sup>	89m <sup>2</sup>	769.2m <sup>2</sup>
Tenant 2.2	1004m <sup>2</sup>		17.6%	132.3m <sup>2</sup>	1136.2m <sup>2</sup>		
Tenant 2.3	244m <sup>2</sup>		4.3%	32.2m <sup>2</sup>	276.2m <sup>2</sup>		
Total Building	5707m <sup>2</sup>		100%	752m <sup>2</sup>	6459m <sup>2</sup>		

1	Tenant Area	2019-02-04
rev:	description:	date:

client: **ATTACQ & ZENPROP**

project: **WATERFALL CORPORATE CAMPUS**

erf no.: **ERF 4256 JUKSKEI VIEW EXT. 117**

**ARCHITECTURE**

Reception: 2nd Floor, 3 Melrose Square, Melrose Arch, +27 11 061 9700 www.lyt.co.za

drawing title: **First Floor tenant layout**

information	tender	construction
ARCH	As indicated	11/29/18
discipline:	scale:	date:
WS	JRB	Checker
design:	drawn:	check:
project: <b>3398</b>	dwg no: <b>03-AR-T2001</b>	rev: <b>1</b>